

DATE	APP'D
1-18-84	CR

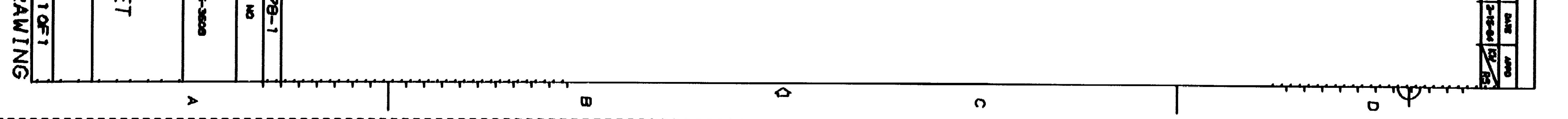

REVISED FOR MULTICATION	7	5	0	4	3	2
OR AMP INCORPORATED, ALL DIMENSIONS, UNLESS OTHERWISE SPECIFIED	.18					
DATE	BY	CHK	APP'D	REV	REV	REV
1-18-84	CR	S3		C		
REVISIONS						
C REV & REDRAW PER CH-11						

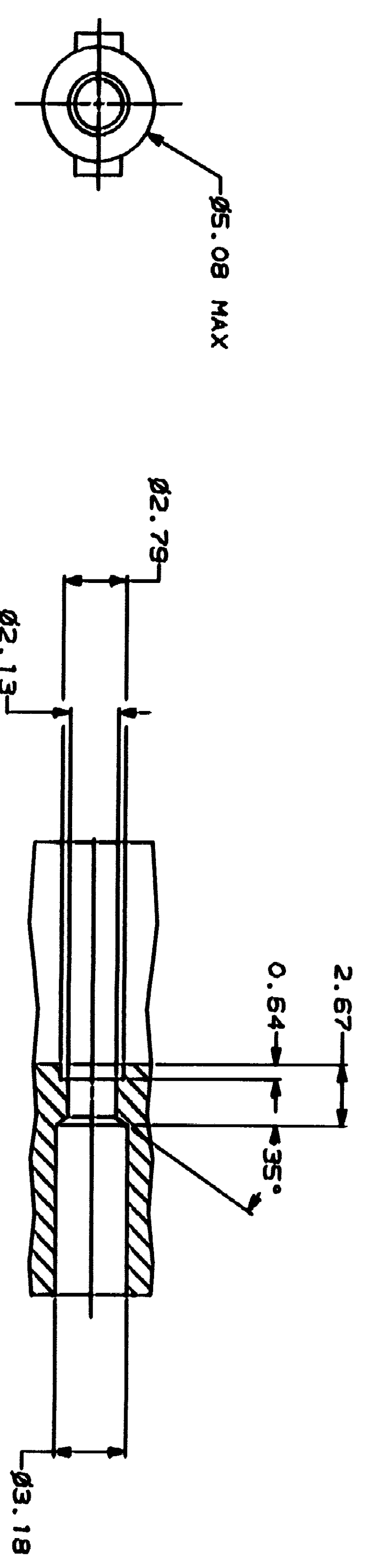
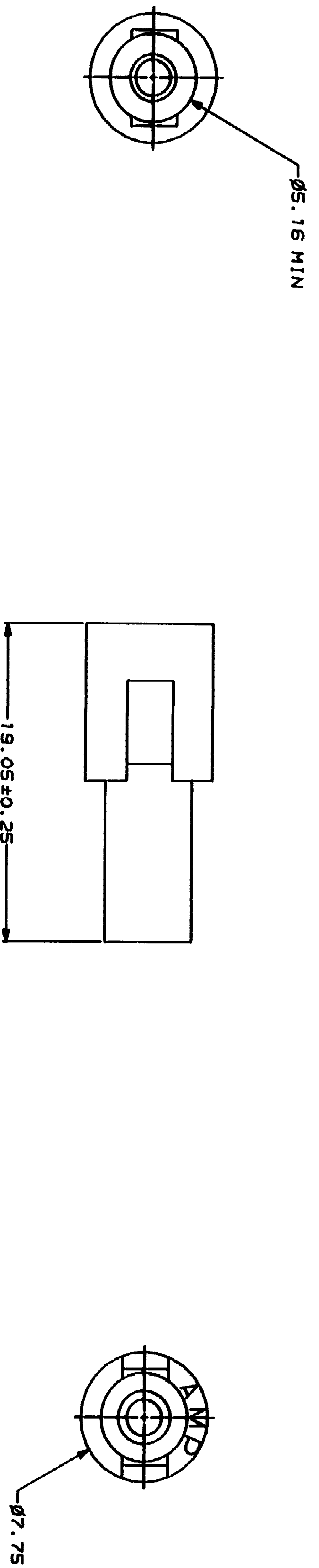

MATING CONNECTOR INTERFACE

TYPICAL PLUG CAVITY SECTION  
(DIMENSIONS REFERENCE ONLY)

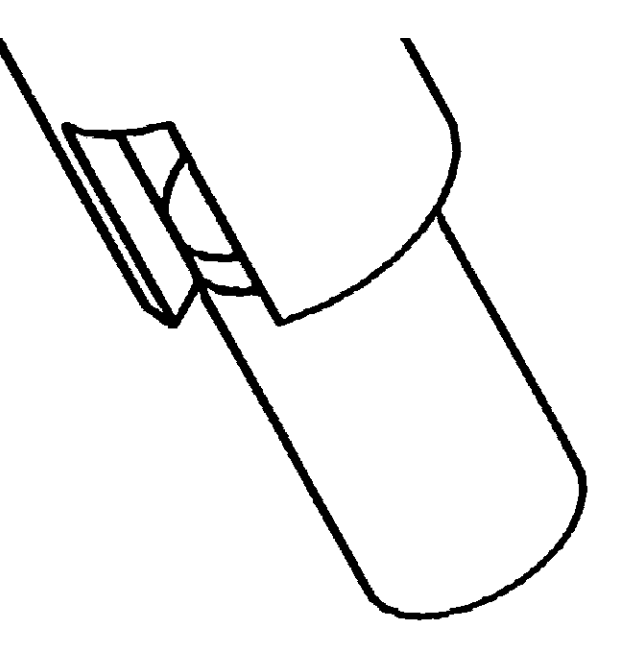

INSIONAL MODEL  
NTS

MM	IN	MM	IN	MM	IN	MM	IN
1.57	.062	3.18	.125	19.05	.750		
0.64	.025	2.79	.110	7.75	.305		
0.25	.010	2.67	.105	5.16	.203		
0.13	.005	2.13	.084	5.08	.200		

CONVERSION TABLE

**METRIC**

THIS DRAWING IS A TECHNICAL DRAWING AND IS NOT TO BE USED FOR CONSTRUCTION OR MANUFACTURE WITHOUT THE EXPRESS WRITTEN PERMISSION OF AMP INCORPORATED.

DO NOT SCALE PRINT. DIMENSIONS SPECIFIED IN MILLIMETERS UNLESS OTHERWISE SPECIFIED DIMENSIONS IN INCHES 2 P.L.C. DEC. ± 0.13 3 P.L.C. DEC. ± 0.13 MATERIALS	DR 2-15-84 K. WILKINS R. SMITH APP'D 2-17-84 C. CLASH PRODUCT SPEC	NAME <b>AMP</b> AMP Incorporated Harrisburg, PA
FINISH NYLON UL 94V-2 NATURAL	APPLICATOR SPEC	PLUG, 1 CIRCUIT .062 PIN AND 50
SCALE 5:1	SIZE D	DATE CODE 00779
		QUANTITY NO. C-770278

CUSTOMER